

MCDONAUGH DRIVE

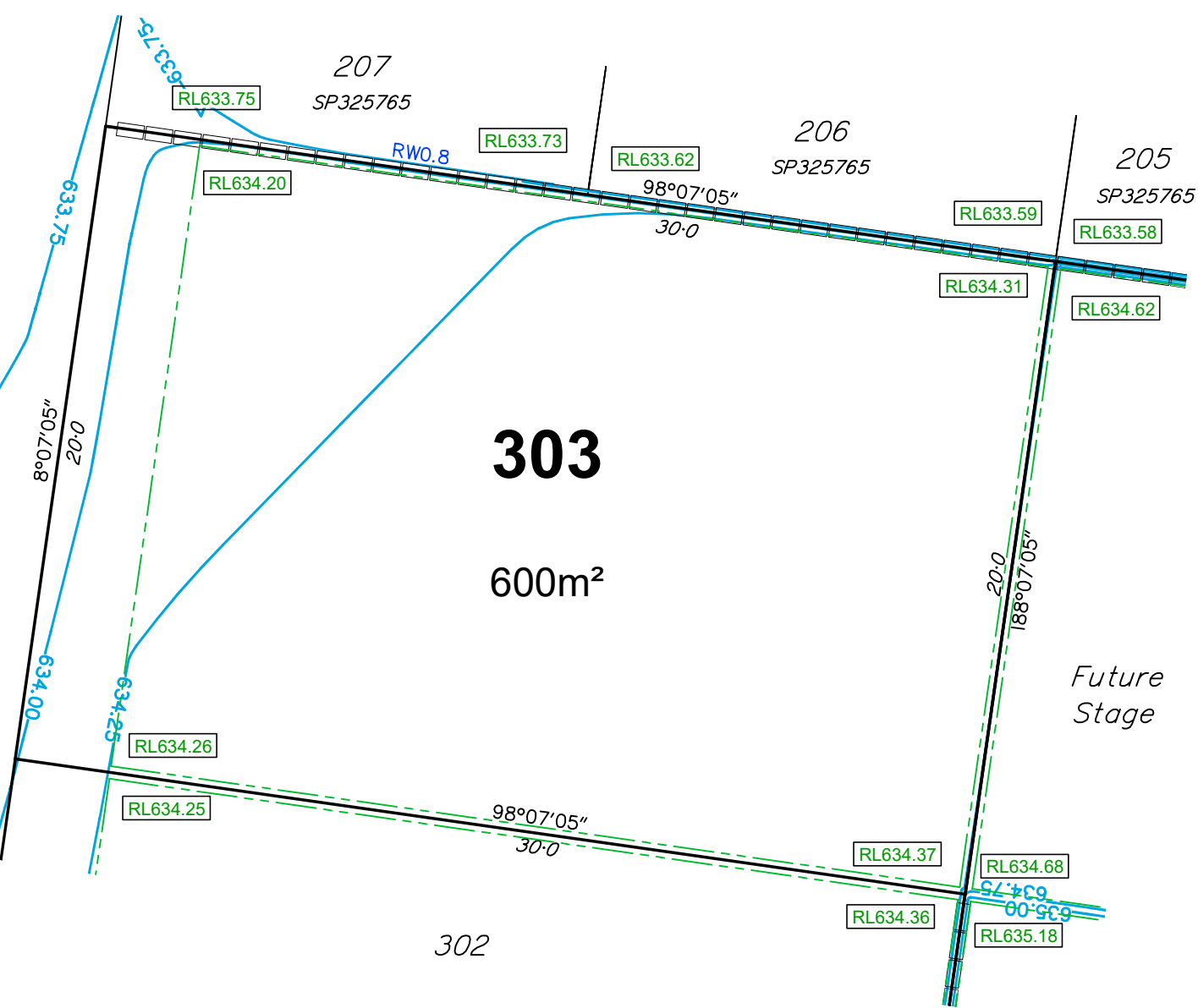

DISCLOSURE PLAN

For Proposed Lot 303
The Avenues of Highfields - Stage 11A

Currently Described As
RPD: Part of Lot 619 on SP329535
Locality: Highfields
Local Authority: Toowoomba Regional

- Legend:**
- 46.0 — Design Surface Contours (0.25m Interval)
 - - - 46.0 - - - Depth of Fill Contours (0.25m Interval)
 - Easement Boundary
 - Edge of Pad
 - Area to be Filled
 - RL57.32 Design Pad Level
 - Retaining Wall
 - RW Retaining Wall Height
 - ARW Average Retaining Wall Height (Retaining Wall Heights shown on the lowside of the wall)
 - // — // Sound Attenuation Fence

- Notes:**
1. This note is an integral part of this plan.
 2. Finished surface contours, depth of fill contours, retaining wall details and proposed services provided by GenEng Solutions on 23-04-2025.
 3. Location of retaining walls are indicative only. Site conditions will dictate construction limits to the material, location, length & thickness of these walls.
 4. This plan has been prepared under the current legislation for the purpose of presales and should not be used for any other purpose. This plan may not contain all services which affect the subject lot and is based on design information only. This plan should not be used for any detailed designs.
 5. Compaction of fill to be completed in accordance with AS3798-2007 under Level 1 supervision.
 6. This plan has been prepared by Therefor Group Pty Ltd, Cadastral Surveyor to satisfy Section 11 of the Land Sales Act QLD 1984 (as amended).

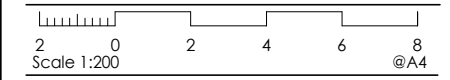

HORIZONTAL MERIDIAN: MGA
LEVEL DATUM: AHD.

DATE DRAWN: 15-01-2026
DRAWING NO.: SB3272_11A-03-303
VERSION: B